

DENTAL OFFICE SPACE FOR SALE

WHAT
MATTERS
TO YOU...



LOCATION

WALKING DISTANCE TO
DUPONT CIRCLE METRO



SIZE

1,600 RSF

IMPERIAL HOUSE CONDOMINIUM

1601 18TH ST NW, SUITE 3
WASHINGTON, DC 20009

ADDITIONAL FEATURES

- Waiting room, reception area, 2 bathrooms, 7 operatories, sterilization and private office
- Commercial ground floor unit currently used as dental office but perfect for professional office uses as well
- Mixed use building with 162 residences, 24-hour front desk, rooftop deck & bike storage
- Built out dental office available for sale, very rare to find in DC

CONTACT US TODAY

ANDREW PAPANTONIOU
ANDREW@GZREALTY.NET

3 Bethesda Metro Center, Suite 700 // Bethesda, MD 20814
301.235.1300 // gzrealty.net





IMPERIAL HOUSE CONDOMINIUM

1601 18TH ST NW, SUITE 3
WASHINGTON, DC 20009

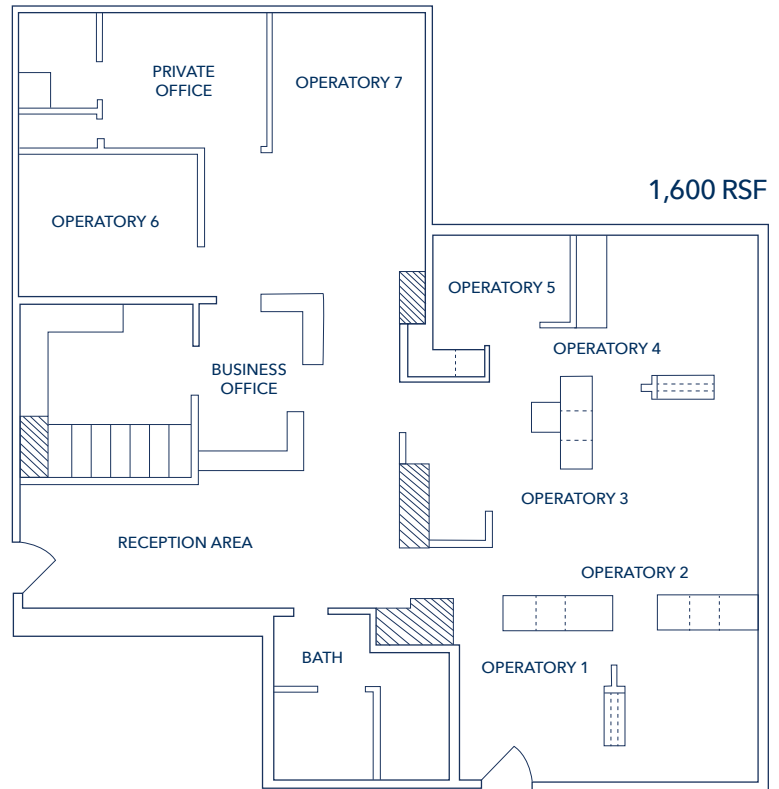

CONTACT US TODAY

ANDREW PAPANTONIOU
ANDREW@GZREALTY.NET

3 Bethesda Metro Center, Suite 700 // Bethesda, MD 20814
301.235.1300 // gzrealty.net